



# The Rise

Kingsthorpe Village, Northampton

oriordanbond  
SALES & LETTINGS



GROUND FLOOR  
583 sq.ft. (54.2 sq.m.) approx.

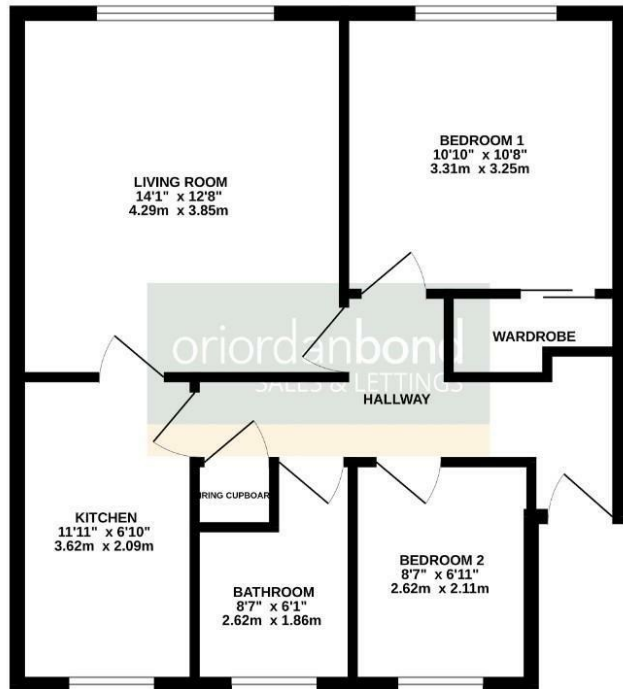

TOTAL FLOOR AREA : 583 sq ft. (54.2 sq.m.) approx.  
Whilst every attempt has been made to ensure the accuracy of the floorplan contained herein, measurements of doors, windows, rooms and any other items are approximate and no responsibility is taken for any error, omission or mis-statement. This plan is for illustrative purposes only and should be used as such by any prospective purchaser. The services, systems and appliances shown have not been tested and no guarantee as to their operability or efficiency can be given.  
Made with Metropack 10/2020

## The Rise

Kingsthorpe Village

NN2 6QQ

PRICE £120,000

A two bedroom first floor maisonette situated in the highly sought after location of Kingsthorpe Village. Offered for sale with no onward chain, the property is located near to many local amenities.

The accommodation comprises secure entrance hall, spacious sitting/dining room, kitchen, re-fitted three-piece bathroom suite and two generous well proportioned bedrooms with fitted wardrobes to the master. Outside is a generous communal rear garden and a garage located in a nearby block. Further benefits include double glazing throughout and a newly extended lease. (B/583/-)

Leasehold Information: Lease Remaining - 120 years (as of 2026) / Ground Rent - £100 per annum / Service Charge - £1000 per annum

### Additional information

- Council Tax Band: A
- Energy Efficiency Rating: D

### Viewing

Viewing strictly by appointment – details below

### Disclaimer

O'Riordan Bond Estate Agents Limited has not tested apparatus, equipment, fittings or services and so cannot verify they are in working order. The buyer is advised to obtain verification from their solicitor or surveyor.

O'Riordan Bond Kingsthorpe Sales

01604 722007

kingsthorpe@oriordanbond.co.uk

